

# PSD 42x/43x

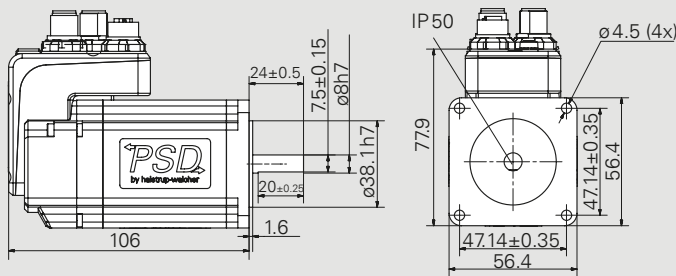

**PSD 422-8V (solid shaft)**



**PSD 432-8 / 14H (hollow shaft, 2 Nm)**

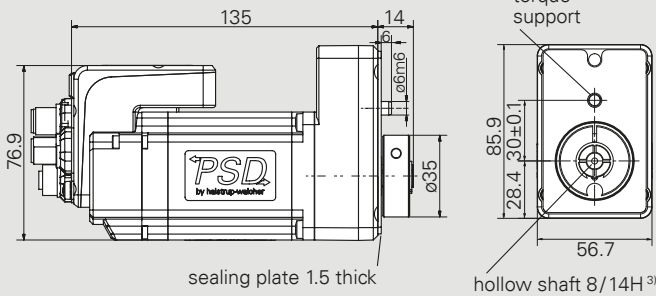

**PSD 426-8 / 14H (hollow shaft, 4, 6 und 8 Nm)**

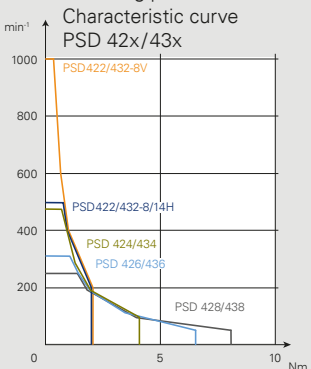
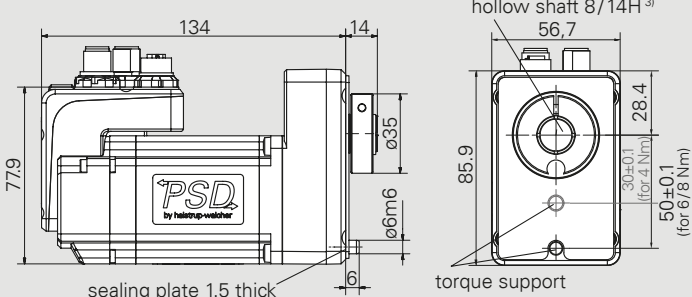

| 3) Hollow shaft       | ø8 <sup>5)</sup> | ø14 |
|-----------------------|------------------|-----|
| <b>Tolerance</b>      | H7               |     |
| <b>Plug depth</b>     | 20               |     |
| <b>Cylinder screw</b> | DIN 912 M4 x 16  |     |

<sup>5)</sup> only up to 5 Nm possible

Dimensions in mm

| PSD 42x/43x | Nominal torque / Nominal rated speed <sup>1)</sup> | Self-holding torque (energized) | Max. speed             | Positioning range <sup>2)</sup> |
|-------------|--|---------------------------------|------------------------|---------------------------------|
| 2-8V        | 2 Nm/200 min <sup>-1</sup>                         | 1 Nm                            | 1000 min <sup>-1</sup> | 4026 rot.                       |
| 2-8H        | 2 Nm/200 min <sup>-1</sup>                         | 1 Nm                            | 500 min <sup>-1</sup>  | 4026 rot.                       |
| 2-14H       | 2 Nm/200 min <sup>-1</sup>                         | 1 Nm                            | 500 min <sup>-1</sup>  | 4026 rot.                       |
| 4-14H       | 4 Nm/100 min <sup>-1</sup>                         | 2 Nm                            | 482 min <sup>-1</sup>  | 1938 rot.                       |
| 6-14H       | 6 Nm/63 min <sup>-1</sup>                          | 3 Nm                            | 317 min <sup>-1</sup>  | 1274 rot.                       |
| 8-14H       | 8 Nm/50 min <sup>-1</sup>                          | 4 Nm                            | 250 min <sup>-1</sup>  | 977 rot.                        |

<sup>1)</sup> at nominal supply voltage

<sup>2)</sup> not subject to mechanical limits

|  |  |
|--|--|
| Supply voltage   | 24 VDC ± 10 %<br>galvanically separated between motor and control                          |
| Nominal current  | 4.0 A  |
| Power consumption (control unit)                             | 0.1 A  |
| Positioning accuracy   | ± 0.7° for 8 Nm<br>± 0.8° for 6 Nm<br>± 1.1° for 4 Nm<br>± 1.8° for 2 Nm                   |
| Absolute measurement system                                  | magnetic, without reference run, without buffer battery                                    |
| Shock resistance in accordance with IEC/DIN EN 60068-2-27    | 50 g 11 ms<br>± 3 shocks pos./neg. per axis  |
| Vibration resistance in accordance with IEC/DIN EN 60068-2-6 | 10..2000 Hz 50 m/s <sup>2</sup> (approx. 5 g)<br>10 frequency cycles                       |
| Output shaft   | 8 mm solid shaft with flattening or 8/14 mm hollow shaft <sup>3)</sup> with torque support |
| Max. axial force   | 30 N, 20 N with attached housing   |
| Max. radial force  | 90 N, 40 N with attached housing   |
| Ambient temperature  | 0..40 °C   |
| Storage temperature  | -10..70 °C   |
| Protection class   | IP 50 or IP 65 <sup>4)</sup>   |
| Weight   | max. 2 kg (1.5 kg without gearbox)   |
| Certificates   | CE/UKCA, opt.: NRTL  |

<sup>3)</sup> see table next to the characteristic curve

<sup>4)</sup> IP65 installed (motor shaft IP50)



## Order code PSD 4 series

| Order code |                   | A                       | B                       | C   | D   | E                         | F                                    | G   | H                                      |   |                     |   |                  |   |              |
|------------|-------------------|-------------------------|-------------------------|---|---|---------------------------|--------------------------------------|---|--|---|---------------------|---|------------------|---|--------------|
| PSD        |                   |                         |                         |   |   |                           |                                      |   |  |   |                     |   |                  |   |              |
| A          | Type              | B                       | Torque/<br>Output shaft | C   | Rotation shaft/<br>Housing  | D                         | Bus<br>communication <sup>1)</sup>   | E   | Electical<br>connections               | F | Protection<br>class | G | Software modules | H | Certificates |
|            | 40:<br>horizontal | with gearbox:           | 1-5V<br>1-8H<br>1-14H   | S: direct or 0°<br>1: 90°<br>2: 180°<br>3: 270° | CA: CANopen<br>IO: IO-Link<br>PN: PROFINET<br>EC: EtherCAT<br>EI: EtherNet/<br>IP | 0: standard <sup>2)</sup> | 50: IP 50<br>65: IP 65 <sup>3)</sup> | 1: standard<br>M: with modulo function <sup>4)</sup><br>S: with changeover of<br>parameter set <sup>4)</sup><br>P: with target speed<br>in process data <sup>4)</sup><br>Z: with modulo function<br>and changeover of<br>parameter set and target<br>speed in process<br>data <sup>4)</sup> | 0: CE / UKCA<br>N: NRTL +<br>CE / UKCA |   |                     |   |                  |   |              |
|            | 41:<br>vertical   |                         | 3-8H<br>3-14H           |   |   |                           |                                      |   |  |   |                     |   |                  |   |              |
|            | 42:<br>horizontal | 2-8V<br>2-8H<br>2-14H   |                         |   |   |                           |                                      |   |  |   |                     |   |                  |   |              |
|            | 43:<br>vertical   | 4-14H<br>6-14H<br>8-14H |                         |   |   |                           |                                      |   |  |   |                     |   |                  |   |              |
|            | 48:<br>horizontal | 0-5V<br>0-8H<br>0-14H   |                         |   |   |                           |                                      |   |  |   |                     |   |                  |   |              |
|            | 49:<br>vertical   | 1-8H<br>1-14H           |                         |   |   |                           |                                      |   |  |   |                     |   |                  |   |              |

|               | B                       |                               | C  |  |   |   |   |   |
|---------------|-------------------------|-------------------------------|--|--|---|---|---|---|
|               | Key                     | Torque                        | Output shaft                                     | Rotation shaft/Housing                           |   |   |   |   |
|               | B1-B2                   | B1                            | B2   | S  | 1 | 2 | 3 |   |
| direct        | 1-5V                    | 1: 0.8 Nm                     | 5V: 5 mm solid shaft                             |  | - | - | - |   |
|               | 1-8H<br>1-14H           | 1: 0.8 Nm                     | 8H: 8 mm hollow shaft<br>14H: 14 mm hollow shaft |  |   |   |   |   |
| with gearbox  | 3-8H<br>3-14H           | 3: 3 Nm                       | 8H: 8 mm hollow shaft<br>14H: 14 mm hollow shaft |  |   |   |   |   |
|               | direct                  | 2-8V                          | 2: 2 Nm  | 8V: 8 mm solid shaft                             |   | - | - | - |
| 2-8H<br>2-14H |                         | 2: 2 Nm                       | 8H: 8 mm hollow shaft<br>14H: 14 mm hollow shaft |  |   |   |   |   |
| with gearbox  | 4-14H<br>6-14H<br>8-14H | 4: 4 Nm<br>6: 6 Nm<br>8: 8 Nm | 14H: 14 mm hollow shaft                          |  |   |   |   |   |
|               | direct                  | 0-5V                          | 0: 0.25 Nm                                       | 5V: 5 mm solid shaft                             |   | - | - | - |
|               |                         | 0-8H<br>0-14H                 | 0: 0.25 Nm                                       | 8H: 8 mm hollow shaft<br>14H: 14 mm hollow shaft |   |   |   |   |
| with gearbox  | 1-8H<br>1-14H           | 1: 1 Nm                       | 8H: 8 mm hollow shaft<br>14H: 14 mm hollow shaft |  |   |   |   |   |

<sup>1)</sup> others on request

<sup>2)</sup> standard equipment: 3 plugs / sockets  
with IO-Link: 1 plug

<sup>3)</sup> IP 65 installed (motor shaft IP 50)

<sup>4)</sup> only for IO-Link devices



To place your order, please call us at  
**+49 7661 3963-0** or email us at  
**info@halstrup-walcher.com.**  
 For additional contacts, please visit  
**www.halstrup-walcher.de/en/contact**

# Accessories for our direct drives

The connectors shown here can be used for all direct drives of the PSD 4 series. We are happy to help you find the right accessories, please contact us directly.

| Buscommunication | Power supply (+ databus connector) <sup>1)</sup><br>(for option 0)   | Cable   |
|------------------|--|---|
| CANopen          | <br>Connector set: Order no. 9601.0060  | <b>on request</b>   |
| EtherCAT         | <br>Connector set: Order no. 9601.0112 |   |
| PROFINET         |  |  |
| EtherNet/IP      |  |   |
| IO-Link          | <br>Connector: Order no. 9601.0107    |   |

<sup>1)</sup> see in order code under E

## Software

Use our function blocks, description files or commissioning tools for the various industrial protocols. You can download the files under [www.halstrup-walcher.de/en/software](http://www.halstrup-walcher.de/en/software). To do this, enter your specific product in the drop-down menu that appears and select the Software tab in the tab view. After that, the software components are available to you.

