

PSD 40x/41x



only with hollow shaft



PSD 40x/41x	Nominal torque / Nominal rated speed ¹⁾	Self-holding torque (energized)	Max. speed	Positioning range ²⁾
1-5V	0.8 Nm/200 min ⁻¹	0.4 Nm	800 min ⁻¹	4026 rot.
1-8H	0.8 Nm/200 min ⁻¹	0.4 Nm	500 min ⁻¹	4026 rot.
1-14H	0.8 Nm/200 min ⁻¹	0.4 Nm	500 min ⁻¹	4026 rot.
3-8H	3 Nm/ 50 min ⁻¹	1.5 Nm	250 min ⁻¹	986 rot.
3-14H	3 Nm/ 50 min ⁻¹	1.5 Nm	250 min ⁻¹	986 rot.

¹⁾ at nominal supply voltage

²⁾ not subject to mechanical limits

Mode of operation	S1 ³⁾ , S3
Supply voltage	24 VDC ± 10 % galvanically separated between motor and control
Nominal current	2.0 A
Power consumption (control unit)	0.1 A
Positioning accuracy	± 0.7° for 3 Nm ± 1.8° for 0.8 Nm
Absolute measurement system	magnetic, without reference run, without buffer battery
Shock resistance in accordance with IEC/DIN EN 60068-2-27	50 g 11 ms ± 3 shocks pos./neg. per axis
Vibration resistance in accordance with IEC/DIN EN 60068-2-6	10..2000 Hz 50 m/s ² (approx. 5 g) 10 frequency cycles
Output shaft	5 mm solid shaft with flattening or 8/14 mm hollow shaft ⁴⁾ with torque support
Max. axial force	15 N, 20 N with attached housing
Max. radial force	40 N
Ambient temperature	0..40 °C
Storage temperature	-10..70 °C
Protection class	IP 50 or IP 65 ⁵⁾
Weight	max. 1 100 g (800 g without gearbox)
Certificates	CE/UKCA, opt.: NRTL

³⁾ Use in continuous operation S1 must be checked depending on the application. Please contact our sales department for more information.

⁴⁾ see table next to the characteristic curve

⁵⁾ IP65 only with hollow shaft

PSD 401-5V (solid shaft)

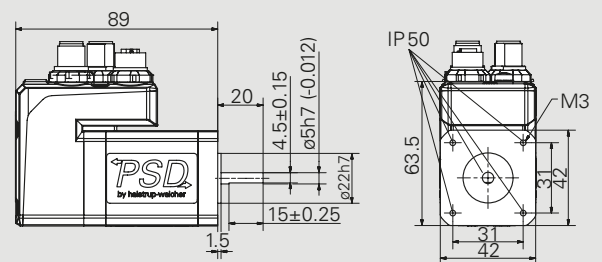

PSD 411-8 / 14H (hollow shaft, 0.8 Nm)

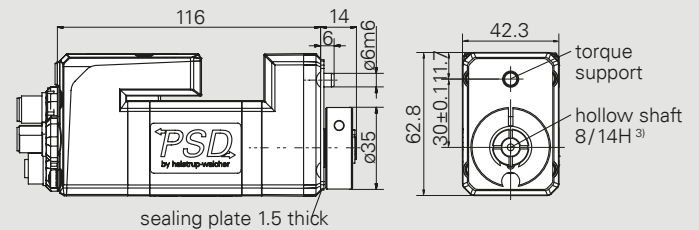



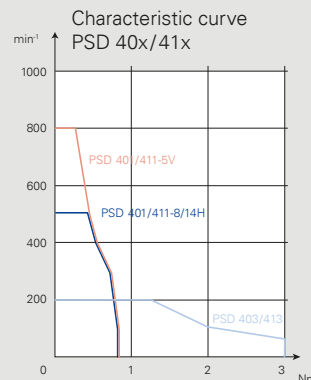
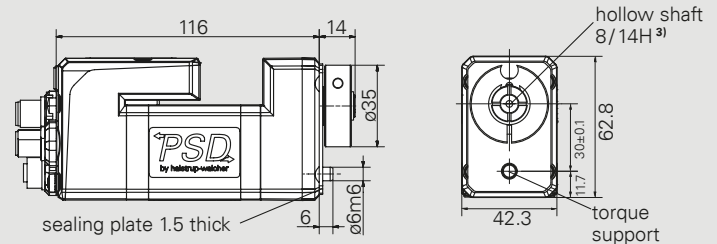

PSD 413-8 / 14H (hollow shaft, 3 Nm)



³⁾ Hollow shaft	ø8	ø14
Tolerance	H7	
Plug depth	20	
Cylinder screw	DIN 912 M4 x 16	

Dimensions in mm

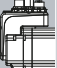
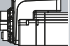
Order code PSD 4 series

Order code		A	B	C	D	E	F	G	H						
PSD															
A	Type	B	Torque/ Output shaft	C	Rotation shaft/ Housing	D	Bus communication ¹⁾	E	Electical connections	F	Protection class	G	Software modules	H	Certificates
	40: horizontal	with gearbox:	1-5V 1-8H 1-14H	S: direct or 0° 1: 90° 2: 180° 3: 270°	CA: CANopen IO: IO-Link PN: PROFINET EC: EtherCAT EI: EtherNet/ IP	0: standard ²⁾	50: IP50 65: IP65 ³⁾	1: standard M: with modulo function ⁴⁾ S: with changeover of parameter set ⁴⁾ P: with target speed in process data ⁴⁾ Z: with modulo function and changeover of parameter set and target speed in process data ⁴⁾	0: CE /UKCA N: NRTL + CE /UKCA						
	41: vertical		3-8H 3-14H												
	42: horizontal	2-8V 2-8H 2-14H													
	43: vertical	with gearbox: 4-14H 6-14H 8-14H													
	48: horizontal	0-5V 0-8H 0-14H													
	49: vertical	with gearbox: 1-8H 1-14H													

	B		C					
	Key	Torque	Output shaft	Rotation shaft/Housing				
	B1-B2	B1	B2	S	1	2	3	
direct	1-5V	1: 0.8 Nm	5V: 5 mm solid shaft		-	-	-	
	1-8H 1-14H	1: 0.8 Nm	8H: 8 mm hollow shaft 14H: 14 mm hollow shaft					
with gearbox	3-8H 3-14H	3: 3 Nm	8H: 8 mm hollow shaft 14H: 14 mm hollow shaft					
	direct	2-8V	2: 2 Nm	8V: 8 mm solid shaft		-	-	-
2-8H 2-14H		2: 2 Nm	8H: 8 mm hollow shaft 14H: 14 mm hollow shaft					
with gearbox	4-14H 6-14H 8-14H	4: 4 Nm 6: 6 Nm 8: 8 Nm	14H: 14 mm hollow shaft					
	direct	0-5V	0: 0.25 Nm	5V: 5 mm solid shaft		-	-	-
		0-8H 0-14H	0: 0.25 Nm	8H: 8 mm hollow shaft 14H: 14 mm hollow shaft				
with gearbox	1-8H 1-14H	1: 1 Nm	8H: 8 mm hollow shaft 14H: 14 mm hollow shaft					

¹⁾ others on request

²⁾ standard equipment: 3 plugs / sockets
with IO-Link: 1 plug

³⁾ IP 65 only with hollow shaft

⁴⁾ only for IO-Link devices



To place your order, please call us at

+49 7661 3963-0 or email us at





info@halstrup-walcher.com.

For additional contacts, please visit

www.halstrup-walcher.de/en/contact

Accessories for our direct drives

The connectors shown here can be used for all direct drives of the PSD 4 series. We are happy to help you find the right accessories, please contact us directly.

Buscommunication	Power supply (+ databus connector) (for option 0) ¹⁾	Cable
CANopen	 <p>Connector set: Order no. 9601.0060</p>	<p>on request</p> 
EtherCAT	 <p>Connector set: Order no. 9601.0112</p>	
PROFINET		
EtherNet / IP		
IO-Link	 <p>Connector: Order no. 9601.0107</p>	

¹⁾ see in order code under E

On request, we offer suitable adapter sleeves for adaptation to different spindle diameters.

Software

Use our function blocks, description files or commissioning tools for the various industrial protocols. You can download the files under www.halstrup-walcher.de/en/software. To do this, enter your specific product in the drop-down menu that appears and select the Software tab in the tab view. After that, the software components are available to you.

